

OVERVIEW - TECH SHEET
COMBINATION WALL
V2 LOW PROFILE BASE

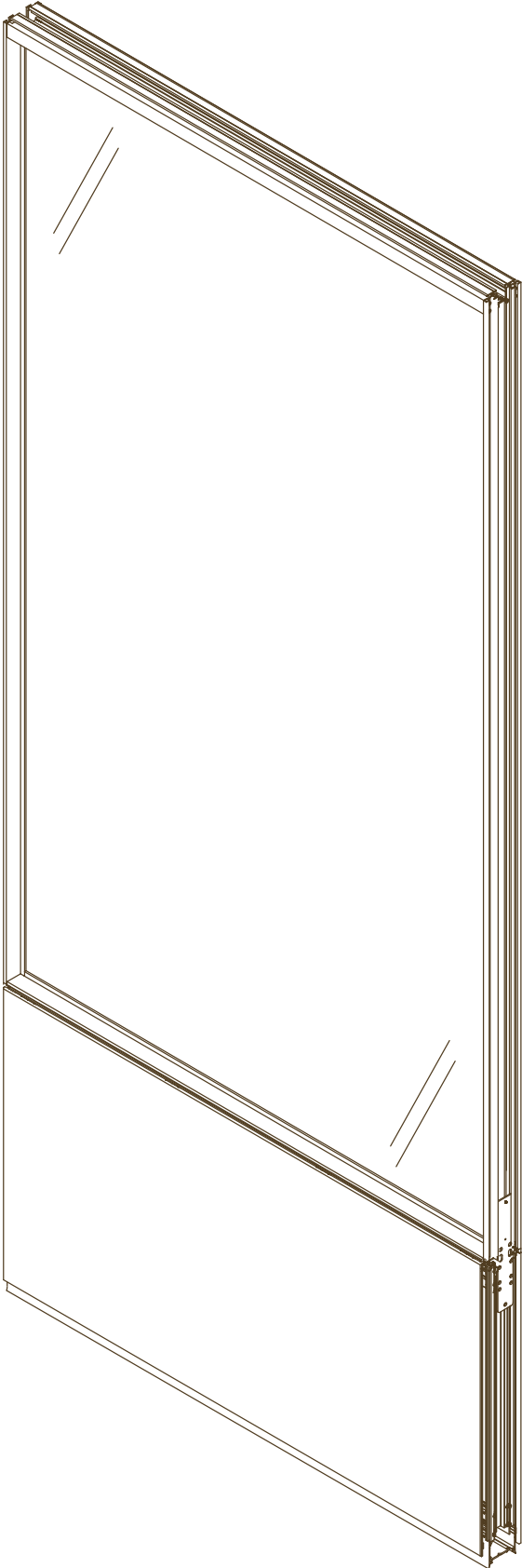

COMPONENTS & MATERIALS

Aluminum Extrusions

Architectural Grade and Structural Aluminum Alloys
Vertical & Horizontal Extrusions, Base Track

Horizontal Sections

Partially exposed Horizontal Support Member for dividing tiles and hanging components; heights user defined.
Hidden Horizontal Member for additional support of face mounted tiles; heights user defined as required.

Insulation

1" (25mm) Thick Fiber Glass – Formaldehyde-free, factory installed in frame. Base Insulation to be field installed in base cavity prior to base trim or scribed tiles.

Base Track

Aluminum Base Track
Steel Leveler Assembly with vertical adjustment
Carpet Grippers
Optional Two Sided Tape for hard flooring
Optional Seismic Base Track

Base Trim

Santoprene Base Trim
Oversized Solid Tiles scribed to floor on site

Face Mount Tile Options

Chroma-coat (painted) Tiles
Wood Veneer on MDF Tiles
Magnetic Whiteboard Tiles
Dry Erase Film on MDF Tiles
Fabric Tiles
Frameless Back Painted Glass Tiles
Slot Wall Tiles (Accessory Rail)
DIRTT Approved Custom Finishes

Center Mount Tile Options

Glass in ¼" (6mm) and ⅜" (10mm) thickness
Clear Tempered Glass
Etched Glass
Laminated Glass
Berman Glass
Back Painted Glass
Chroma-coat (painted) Tiles
Veneer Tiles
Dry Erase Film on MDF Tiles
Fabric Tiles
DIRTT Approved Custom Finishes

PVC Components

Frame Connections	Rigid/Flex Co-extrusion
Ceiling Trim/Wall Start	Rigid/Flex Co-extrusion
Glass Retainer	Rigid/Flex Co-extrusion
PVC Color Options	Black, Charcoal, Silver, Custom as required

DIMENSIONS & DETAILS

Frame

Standard Wall Thickness	4" (102mm) with Tiles
Minimum Module Width	6" (152mm)
Maximum Module Width	48" (1219mm)
Standard Ceiling Height	Up to 120" (3048mm)*
Vertical Height Adjustment	
Standard Base	- ⅜" (9.5mm) and +1 ⅜" (35mm)

*Wall Heights above 120" (3048mm) must be validated by DIRTT to confirm walls do not exceed the maximum allowable deflection per IBC.

Frame Connections

Hidden Links	Frame alignment and gap control
Visible PVC Zipper	At frame connection between frames

Trim Components

Ceiling Trim	Flexible trim from top of wall to ceiling
Wall Trim	Rigid connection from Frame to Base Building; combined with flexible Wall Trim

Other Component Connections to Solid Walls

Glass Panels
Door Frames
Corner Connectors
Various Base Building Connections
Modular Electrical
Conventional Electrical

Other Options

Stacking Configurations	Glass over Solid Solid over Glass Glass over Solid over Glass Solid over Glass over Solid Glass Segment spanning multiple solid frames
-------------------------	--

Low Wall
Cornice Height Wall
Center Steel Septum
Mitered Corner Joint
Extended Levelers for additional leveling capability
Seismic
DIRTT Approved Custom Solutions (Bespoke)
NAUF MDF
Fire Retardant MDF

TESTING & APPROVALS

QPS UL/CSA Level 3, Office Electrical	LPCE-75090-1
Los Angeles Research Report (Seismic)	LARR-25604
Seismic Engineering Calculations	
Seismic Engineering Details	

Testing Reports, Details and Approvals are available upon request.

ISOMETRIC/WALL PANEL

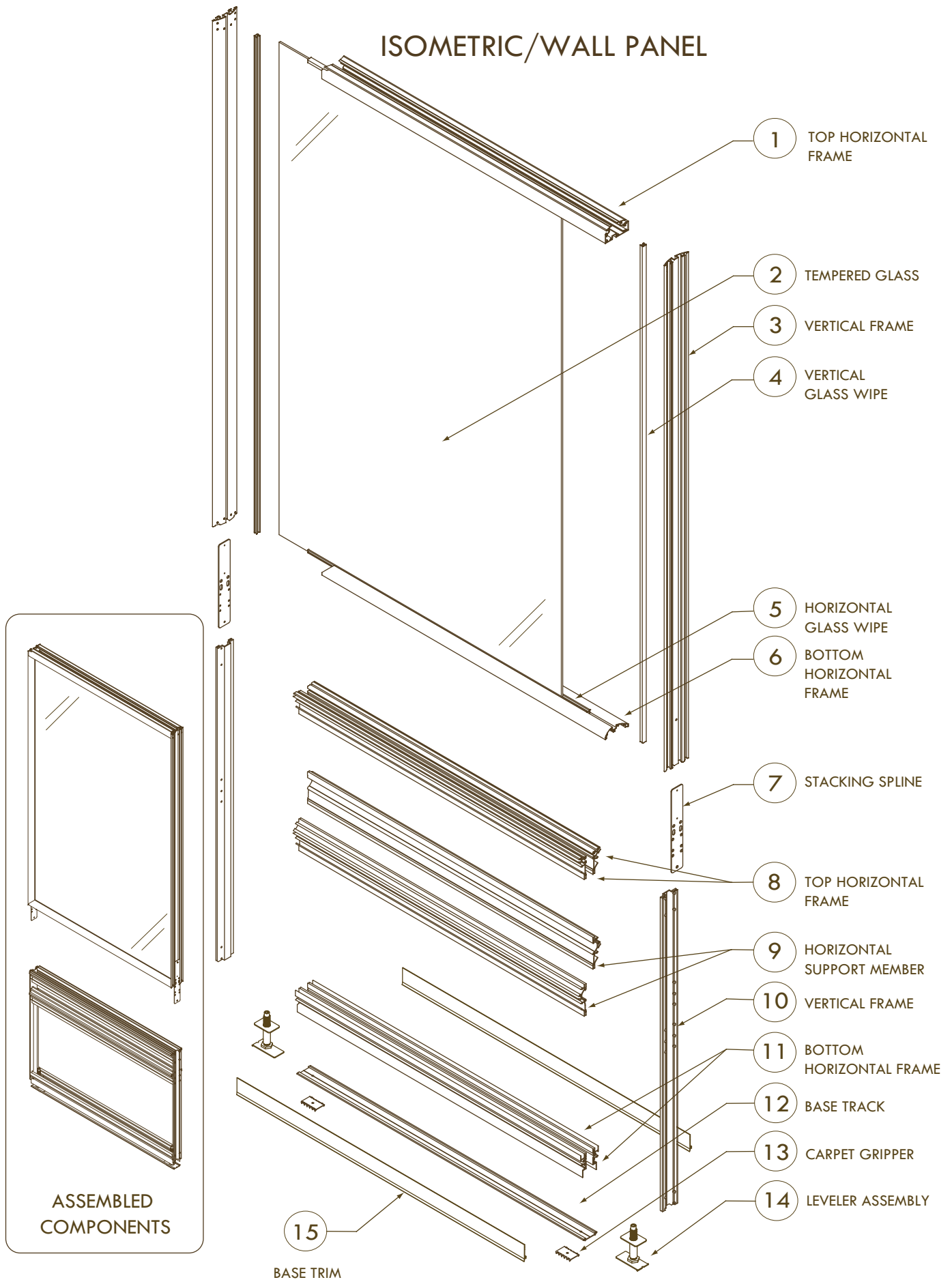

ISOMETRIC/WALL PANEL

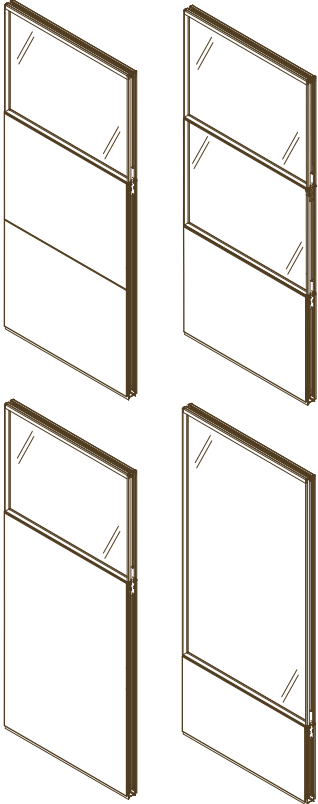

USER DEFINED CONFIGURATIONS

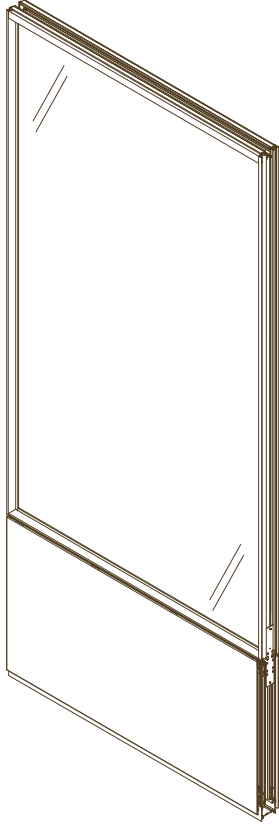

ASSEMBLED

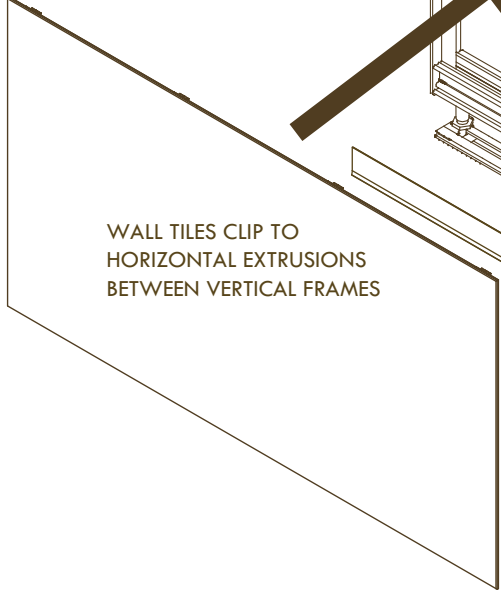

WALL TILES CLIP TO HORIZONTAL EXTRUSIONS BETWEEN VERTICAL FRAMES



BASE TRIM PRESSES INTO BASE TRACK

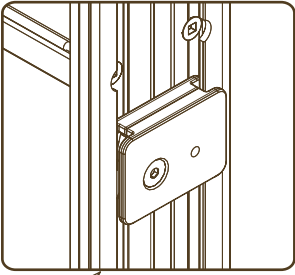

LIPLESS LINKS CONNECT PANEL FRAMES

